

# The Akron Architectural Group

Braun & Steidl Architects ■ GPD Group ■ Hasenstab Architects, Inc. ■ Moody Nolan, Inc. ■ TC Architects, Incorporated ■ URS

## AKRON PUBLIC SCHOOLS

**Community Planning Meeting #3**  
**Sam Salem Community Learning Center**  
**Wednesday, May 4, 2005 @ 6:00 p.m.**

---

### In Attendance

F. Herr.....	Akron Public Schools
E. Marcius .....	Akron Public Schools
L. Yanchek.....	Akron Public Schools
M. Bill .....	Akron Public Schools
N. Bradbary.....	Akron Public Schools
J. Birath.....	AAG
L. Duncan .....	City of Akron
M. Lewis.....	CPT
M Freeman .....	CPT
C. Brady.....	CPT
C. Werling.....	CPT
S. Salem .....	CPT
T. Holman .....	CPT
M. Holman.....	CPT
M. Hartz .....	CPT
B. Speelman.....	CPT
D. Ferguson.....	CPT

### Distribution

AAG Project Managers	
M. Salopek.....	AAG
D. Mitchell.....	AAG
D. James.....	Akron Public Schools
J. Beal.....	Akron Public Schools
K. Balchak.....	Akron Public Schools
R. Jones Blum .....	Akron Public Schools
L. Duncan .....	City of Akron
T. Long.....	City of Akron
M. Williamson .....	City of Akron
D. Krutz.....	RKPS
L. Jennings .....	Burges and Burges

---

The following is a review of items discussed at the meeting:

- F. Herr welcomed everyone to the meeting and thanked those who participated in establishing the Program of Requirements (POR) for their work. He noted that this is the first part of many other phases that will occur over the course of designing the new building. He emphasized the importance of the Community Planning Team's input during the design and planning process and that everyone must participate to ensure a successful Community Learning Center that meets the specific needs of the

community. He stated that the next phase will be the Schematic Design (SD) where we will explore where to locate on the site the building, parking, and play areas and how the rooms in the building will relate to one another in plan.

- J. Birath issued a copy of the Programming Diagram for the new facility and reviewed all of the spaces. The new facility will be a two-story structure for 350 students and be 54,099 square feet. There were not any concerns expressed about the proposed program.
- L. Duncan reviewed the Programming Options/Recommendations chart for the new facility.
  - She noted that this is an on-going effort by the City to identify the needs of the community and how these needs can best be addressed. The chart is a summary of what has been said to date, and will be modified as meetings with providers occur.
  - It was noted that the YMCA currently provides after school care, and that they offer juvenile intervention programs. L. Duncan noted that the City is searching for providers for before school care and extended hours after school care and will discuss these with the YMCA.
  - The City will be speaking with the University of Akron about after school tutoring programs.
  - The chart for this new facility and the charts for other facilities can be viewed at [www.akronschools.com](http://www.akronschools.com)
- J. Birath discussed what will occur during the Schematic Design Phase of the Project. The first task will be to review the site and options for locating the building, parking, and play areas to provide safe access to the new building and play areas. The next task will be to develop relationship diagrams for the spaces and determine where they need to be located relative to one another. This will be used to develop floor plans and elevations. This will require the involvement of the Roll-up the Sleeves Team and Community Planning Team. The design of the building will be a response to what requirements the Team expresses. The Team will respond to the design and the design will be modified to incorporate the decisions. There will be an exchange of ideas and proposed solutions to create a design that meets the requirements of the community.
- Roll-up the Sleeves Team and Community Planning Team meeting dates have not been established and will be coordinated through E. Marcius.

The preceding is AAG's interpretation of the meeting. Any changes, additions, or clarifications should be forwarded to our office as soon as possible. Unless these changes are furnished within ten (10) working days, it will be understood that all parties are in agreement with the preceding statements.

**academic core**

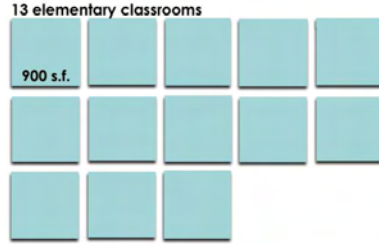
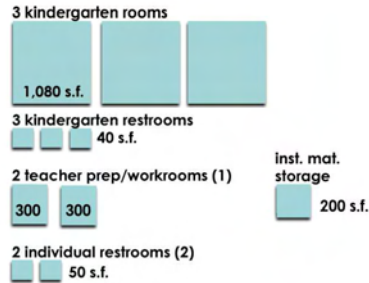

**special education**

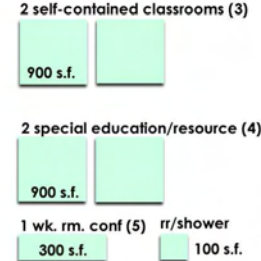

**art**

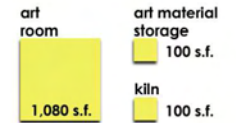

**music**

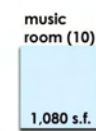

**administration**

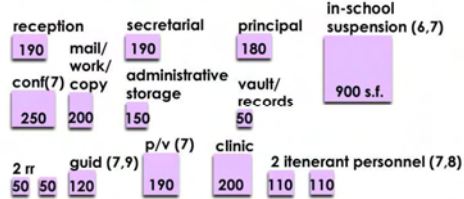

**media center**

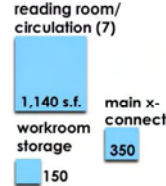

**physical education**

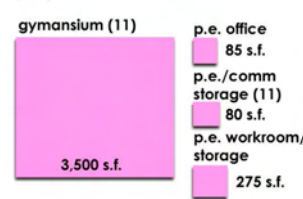

**student dining**

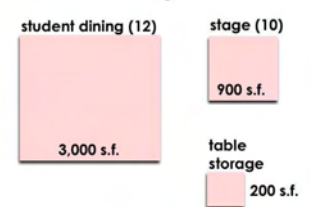

**building services**

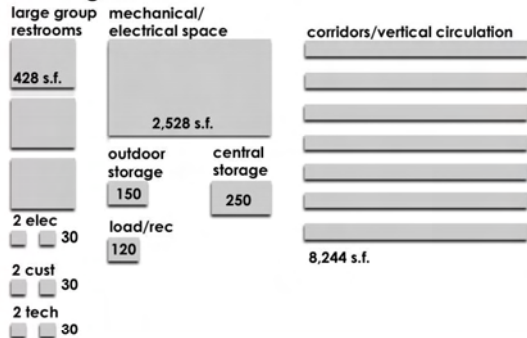

**food services**



**custodial spaces**



**NOTES:**

- (1) ONE TEACHER PREP WORKROOM PER FLOOR.
- (2) EACH RESTROOM LOCATED ADJACENT TO TEACHER PREP/WORKROOM.
- (3) MULTIPLE DISABILITY & ORTHOPEDICALLY IMPAIRED
- (4) PHYSICAL THERAPY & OCCUPATIONAL THERAPY (PT/OT) IN EACH ROOM
- (5) SPEECH THERAPIST IN WORKROOM/CONFERENCE
- (6) TO HOUSE TITLE 1 AND ESL INTERPRETERS (W/ OPERABLE PARTITIONS)
- (7) TO BE USED BY OHIO READS
- (8) ESL INSTRUCTOR WORKSPACE
- (9) SHARED BY PSYCHOLOGIST & COUNSELOR
- (10) MUSIC ROOM TO BE USED FOR GENERAL MUSIC CLASS, ORCHESTRA & BAND. STAGE CAN BE USED FOR CONFLICTS IN SCHEDULE.
- (11) AFTER SCHOOL PROGRAMS IN GYM
- (12) CHESS CLUB & CLUB INVENTION IN STUDENT DINING AFTER SCHOOL.



**PROGRAMMING DIAGRAM 350 Students 54,099 SF**

## Sam Salem CLC Programming Options/Recommendations

Program	Support/Need	Space Required	Provider/ Partner	Challenges to Implementation	Time	Comments
Extended before and after school daycare	Very strong	Classroom Auditeria	Search	Security	6:30 A.M. to 7:00 P.M.	Absolute necessity, desired at each CLC
Child care during community use	Strong	Classroom Auditeria LRC	Search	Security, space and scheduling conflicts	Evenings Weekends Year-round	Critical to success of CLC concept, enables parents, especially single parents to access programming
After-school tutoring	Strong	Classroom LRC	APS Search	Security, space and scheduling conflicts, funding	After school, weekends, summer	Viewed as important by teachers and residents
Non-traditional enrichment programs, art, music, dance college courses	Strong	Classroom LRC Art Room Music Room	APS Search	Security, space and scheduling conflicts, funding	After school, weekends, summer	Viewed as important by teachers and residents
Open gym/rec program, including fitness classes for adults and seniors	Strong	Gym	APS City Search	Security, space and scheduling conflicts	After school, weekends, summer	Residents expressed need for open gym time for kids to just “run and play,” “lifesaver” in winter
Senior programs, including computer skills and programs in which seniors teach skills such as sewing, quilting, cooking to younger people	Strong	Classroom LRC Art Room Music Room Auditeria Gym	Search	Security, space and scheduling conflicts	Evenings Weekends Summer During school day	Especially important since existing senior center in Kenmore is separated from the neighborhood. Wide range of programs discussed including computer

						courses, fitness, mentoring, sewing, etc.
Juvenile Intervention program	Strong	LRC Conference room	Juvenile Court City	Security, space and scheduling conflicts, funding	After school, weekends, summer	Identified as need by teachers, staff, residents
Program	Support/Need	Space Required	Provider/ Partner	Challenges to Implementation	Time	Comments
Group meetings	Strong	Classroom Auditeria LRC Conference rooms	N/A	Security, space and scheduling conflicts	Evenings Weekends Year-round During school hours	Identified as important community need by residents who said there is a serious lack of meeting space in the neighborhood
Social Service Agencies (CSB, CSEA, JFS)	Strong	Conference rooms LRC	County City	Security, space and scheduling conflicts	During school day, evenings Year-round	Identified as community need by residents, agencies would use conference room on regularly scheduled, rotating basis, JFS may utilize LRC for training, adult ed.
Adult Education	Strong	Classroom LRC Auditeria Conference rooms	KSU AU APS Search	Security, space and scheduling conflicts, funding	Evenings Weekends Year-round	Residents identify as critical need, tied to changing economy, difficulty in obtaining good jobs
Faith-based groups	Moderate	Gym Auditeria LRC Music	N/A	Security space and scheduling conflicts	Evenings Weekends Year-round	Residents believe faith-based organizations should be allowed

		<b>Room Art Room</b>				<b>to use CLC spaces for programming</b>
--	--	--------------------------	--	--	--	--

Programming options are not necessarily listed in order of importance. Options are based on input from residents and staff gained at CPT meeting #2.