

520 South Main Street  
Suite 2531  
Akron, OH 44311  
PH 330.572.2100  
FX 330.572.2102

# The Akron Architectural Group

Braun & Steidl Architects ■ GPD Group ■ Hasenstab Architects, Inc. ■ Moody Nolan, Inc. ■ TC Architects, Incorporated ■ URS

## AKRON PUBLIC SCHOOLS

**Community Planning Meeting #3**  
**Ritzman Community Learning Center**  
**Tuesday, May 3, 2005 @ 6:00 p.m.**

---

### In Attendance

J. Beal.....	Akron Public Schools
G. Taylor.....	Akron Public Schools
J. Kaufman.....	Akron Public Schools
C. Iwanski.....	AAG
L. Duncan.....	City of Akron
L. Jennings.....	Burgess & Burgess
R. Slater.....	CTP
K. Olsen.....	CTP
R. King.....	CTP
D. King.....	CTP

### Distribution

AAG Project Managers	
M. Salopek.....	AAG
D. Mitchell.....	AAG
D. James.....	Akron Public Schools
J. Beal.....	Akron Public Schools
K. Balchak.....	Akron Public Schools
R. Jones Blum.....	Akron Public Schools
L. Duncan.....	City of Akron
T. Long.....	City of Akron
M. Williamson.....	City of Akron
D. Krutz.....	RKPS
L. Jennings.....	Burges and Burges

---

The following is a review of items discussed at the meeting:

- J. Beal introduced the team members from Akron Public Schools (APS), City of Akron, and Akron Architectural Group (AAG) that would be assisting the community and staff with the process.
- G. Taylor issued thanks to participants and stated that their input is invaluable to the design and program to the new Ritzman CLC.
  - G. Taylor stressed that we will continue to gather input on the design and programming of the new school and it is critical that the community provides feedback and ideas.
- J. Beal introduced C. Iwanski. C Iwanski thanked everyone for attending and briefly explained the process of using the OSFC predetermined standards during the POR (Program of Requirements) process and developing them into the new Ritzman CLC building program.

- C Iwanski directed everyone's attention to the Programming Diagram to review the POR as a graphic representation of building spaces that the RUS team has developed during several meetings.
  - The POR is designed to include 400 students and 56,279 SF. Due to site restraints, Ritzman will have a 2-story classroom wing.
  - During the RUS (Roll-Up the Sleeves) process, there was a strong push for corridor lockers. C Iwanski stated lockers couldn't be in the corridors as determined by APS. G. Taylor explained the square feet the lockers would require in the corridors due to code egress issues will be taken out of the classrooms. Although it would add classroom wall space for instructional accessories, APS prefers keeping the lockers in the classrooms for monitoring of children during school start and dismissal.
    - There was concern that the lockers would be noisy and would cause disruptions in the classrooms. G. Taylor stated they would be quiet-type lockers that are approximately 15"x15". Parents agreed there is more security with keeping them inside classrooms due to students having personal items stolen, etc. J Beal stated there would be approximately 30 lockers per classroom.
  - The technology of the Academic and Media Center was discussed. J Beal stated that the base bid for each CLC will include a ceiling mounted projector in each classroom and the Media Center, and Student Dining.
  - C Iwanski discussed proximity of special education rooms that will be separated by being on opposing ends of the buildings and one on each floor due to the FM Frequency equipment used for the hearing impaired programs. An elevator will be provided for ADA accessibility.
  - When reviewing the Food Services, L Duncan stated the program includes a community kitchenette for community functions. Currently, the existing kitchenette houses Title 1 services because of current enrollment numbers.
- L Duncan reviewed the CLC Programming Options and Recommendations and reinforced that this is a school first and the programming of the school takes precedence. L Jennings stated that these are programs that the community has said that they would like to see in their CLC and there is heavy use already.
- L Duncan suggested the City is open to other programs that maybe available. L Jennings stated that they are looking into a day care program that is affordable for each area.
- L Jennings stated there is a strong interest by KSU for hearing impaired programs. J Beal stated citywide, this area has the highest incidences of hearing impaired.
  - There are advantages in having these programs in their neighborhoods. He stated since these are Community Learning Center's; the residents take ownership of these buildings. There is less chance of vandalism when there is ownership. J Beal noted an instance of another NE Ohio school where the students performed better in their new school.
- L Duncan reinforced that there will be a committee set up with the community and APS to approve and decide fee structure as well as the use groups.
- Residents questioned whether the new CLC is open to other communities. L Jennings stated there is not a lot of crossing of community clusters but these are open to Akron residents. More than likely, the programs held by the community are for that particular community.
- J. Beal stated the next process is Schematic Design (SD) and we will continue to team with the RUS committee and the community to develop space layout. Milestone dates are as follows:
  - Completion of POR this month. It will be sent down to Columbus for approval.

- Schematic Design: November 2005
  - Design Development: November 2006
  - Construction Documents: April 2007
  - Project goes to bid July 2007
  - Groundbreaking is in October 2007
  - Completed projected for June 2009.
- The next community meeting during SD will be determined at a later date. Jim Beal will let J. Kaufman know when the next SD meeting is.

The preceding is AAG's interpretation of the meeting. Any changes, additions, or clarifications should be forwarded to our office as soon as possible. Unless these changes are furnished within ten (10) working days, it will be understood that all parties are in agreement with the preceding statements.

**academic core**

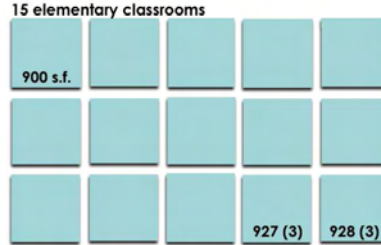
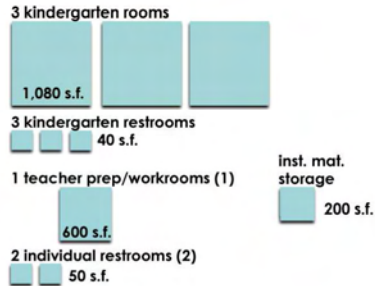

**special education**

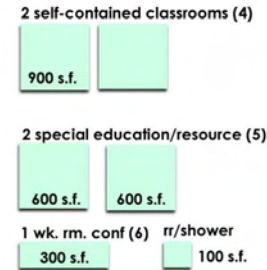

**art**

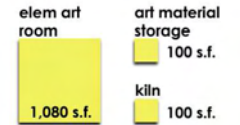

**music**

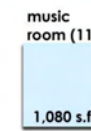

**adminstration**

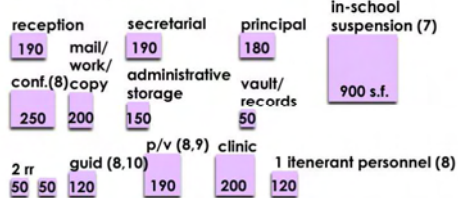

**media center**

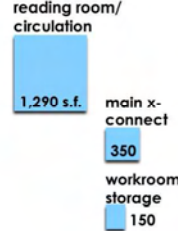

**physical education**

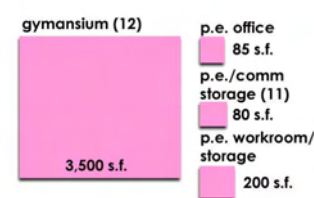

**student dining**



**building services**

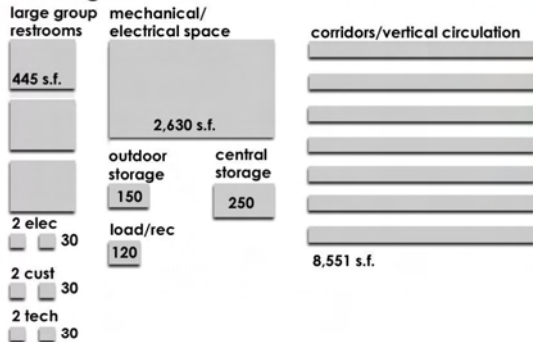

**food services**

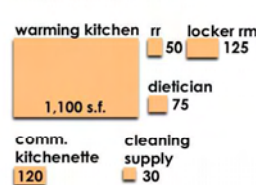

**custodial spaces**



**NOTES:**

- (1) ONE TEACHER PREP WORKROOM ON FIRST FLOOR.
- (2) RESTROOM LOCATED ADJACENT TO TEACHER PREP/WORKROOM ON FIRST FLOOR AND NEAR THE GROUP RESTROOM ON THE SECOND FLOOR.
- (3) ONE CLASSROOM ON EACH FLOOR TO BE ENLARGED.
- (4) CD/SLD EACH TO USE 1/2 OF ROOM (W/ OPERABLE PARTITION)
- (5) HEARING IMPAIRED IN EACH ROOM- ONE ROOM PER FLOOR ON OPPOSING ENDS.
- (6) SPEECH THERAPIST TO UTILIZE WORKROOM/CONFERENCE.
- (7) TO HOUSE FOUR TITLE 1 TUTORS (W/ OPERABLE PARTITION).
- (8) TO BE USED BY OHIO READS
- (9) INTERPRETER WORK ROOM
- (10) SHARED BY PSYCHOLOGIST, COUNSELOR, AND LEARNING SPECIALIST
- (11) MUSIC ROOM TO BE USED FOR GENERAL MUSIC CLASS, ORCHESTRA AND BAND. STAGE CAN BE USED FOR CONFLICTS IN SCHEDULE.
- (12) AFTER SCHOOL PROGRAMS IN GYM AND STUDENT DINING.



**PROGRAMMING DIAGRAM 400 Students 56,279 SF**

## Ritzman CLC Programming Options/Recommendations

Program	Support/Need	Space Required	Provider/ Partner	Challenges to Implementation	Time	Comments
Extended before and after school daycare	Very strong	Classroom Auditeria	Search	Security	6:30 A.M. to 7:00 P.M.	Absolute necessity, desired at each CLC
Child care during community use	Strong	Classroom Auditeria LRC	Search	Security, space and scheduling conflicts	Evenings Weekends Year-round	Critical to success of CLC concept, enables parents, especially single parents to access programming
After-school tutoring	Strong	Classroom LRC	APS Search	Security, space and scheduling conflicts, funding	After school, weekends, summer	Viewed as important by teachers and residents
Non-traditional enrichment programs, art, music, college courses	Strong	Classroom LRC Art Room Music Room	APS Search	Security, space and scheduling conflicts, funding	After school, weekends, summer	Viewed as important by teachers and residents
Open gym/rec program	Strong	Gym	APS City	Security, space and scheduling conflicts	After school, weekends, summer	Residents expressed need for open gym time for kids to just “run and play,” “lifesaver” in winter
Senior programs	Strong	Classroom LRC Art Room Music Room Auditeria Gym	Search	Security, space and scheduling conflicts	Evenings Weekends Summer During school day	Wide range of programs discussed including computer courses, fitness, mentoring, sewing, etc.
Adult Education	Strong	Classroom	KSU	Security, space	Evenings	Residents identify

		LRC Auditeria Conference rooms	AU APS Search	and scheduling conflicts, funding	Weekends Year-round	as critical need, tied to changing economy, difficulty in obtaining good jobs
<b>Program</b>	<b>Support/Need</b>	<b>Space Required</b>	<b>Provider/ Partner</b>	<b>Challenges to Implementation</b>	<b>Time</b>	<b>Comments</b>
<b>Group meetings</b>	<b>Strong</b>	Classroom Auditeria LRC Conference rooms	N/A	Security, space and scheduling conflicts	Evenings Weekends Year-round During school hours	Identified as important community need by residents who said there is a serious lack of meeting space in the neighborhood
<b>Tax preparation and review property tax assessment/process</b>	<b>Moderate</b>	Classroom LRC Conference rooms	Search County	Security, space and scheduling conflicts	Evenings Weekends January to April for tax preparation. As assessment/ reassessmen ts occur	Identified as community need by residents
<b>Faith-based groups</b>	<b>Moderate</b>	Gym Auditeria LRC Music Room Art Room	N/A	Security space and scheduling conflicts	Evenings Weekends Year-round	Residents believe faith-based organizations should be allowed to use CLC spaces for programming
<b>Swimming Pool</b>	<u>Moderate</u>	LFI-funded addition to POR	Search	Funding	Year-round	Community expressed interest in locating a pool

						<b>on the site, noted that nearest such facility is in Green</b>
--	--	--	--	--	--	--

Programming options are not necessarily listed in order of importance. Options are based on input from residents and staff gained at CPT meeting #2.